

M/S SUNWORLD IX



SUNWORLD IX (maximum 16 guests) is 30 metres with 8 spacious cabins. 4 cabins have a double and single bed and 4 have double beds. The cabins and saloon are air conditioned (switched on for siesta and to cool cabins for sleeping but not 24 hour) with all towels provided, bath robes and hair dryers. The bathrooms have shower cubicles and sinks with marble surrounds, the toilets are electric. For dining the salon is very large with sofa seating and bar, the galley is below. On deck the dining table can seat 16 comfortably and there are sun bathing mattresses and cushions for relaxing as well as sofa seating and small tables forward for pre-dinner drinks. There are 4 crew members and the captain, who we know personally, speaks English.



Double cabin



Twin cabin



Bathroom



Saloon



Corridor



Aft deck



Foredeck



Sun cushions



In a bay

M/S SUNWORLD IX

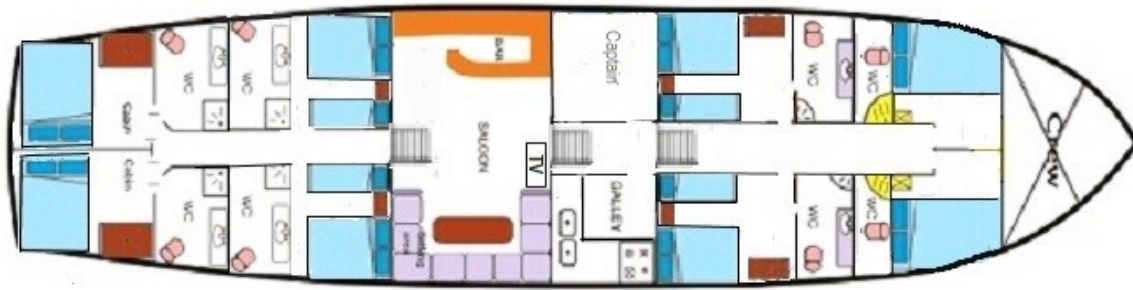

TECHNICAL DATA

Length overall : 30 metres
Beam : 7.30 metres
Draft : 3.60 metres
Engine : 446 HP Caterpillar
Electricity : 12, 24 & 220 Volts
Cruising speed : 10 knots
Generators : 33 & 22 kva

EQUIPMENT ON BOARD

VHF radio telephone
Radar, GPS depth sounder, AIS, Wi - Fi
CD stereo music system, iPod connection
Colour TV & DVD player
Refrigerator, freezer, ice maker and watermaker
Speedboat with 50 HP outboard motor and water-ski
Windsurf & Canoe
Snorkelling equipment
Fishing lines
Full safety & fire fighting equipment

ACCOMMODATION

8 air conditioned cabins
4 double cabins & 4 cabins with a double & single bed
En suite bathrooms
Separate crew quarters