

M/S SUNWORLD 8



SUNWORLD 8 (maximum 16 guests) was extensively re-fitted in 2009. It is 30 metres and has 8 spacious cabins with high ceilings and plenty of wardrobe space. The 4 rear cabins have double beds whilst forward there is 1 double bed cabin, 1 with both a double and single bed and 2 twin cabins. The en suite bathrooms have electric toilets and shower cubicles. It is a very good yacht for families, parents can stay on one side and the children can feel like they have their own private space. The cabins and the saloon are air conditioned (switched on for siesta and to cool cabins for sleeping but not 24 hour). The large saloon has a bar, dining area and up to date LCD television, DVD player, music system and iPod connection. The lounging areas on deck have sun bathing cushions covered by sun awnings and the outdoor table can sit 16 guests comfortably.



Double cabin



Aft double cabin



Triple cabin



Bathroom



Saloon



Aft deck



Sitting area



Sun beds

M/S SUNWORLD 8

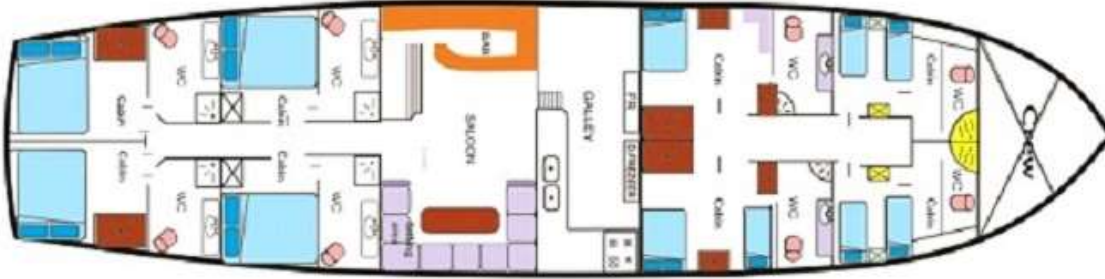

TECHNICAL DATA

Length overall : 30 metres
Beam : 6.80 metres
Draft : 2.60 metres
Engine : 360 hp IVECO
Generators : 21 & 30 KWA
Electricity : 24 & 220 Volt
Cruising speed : 9 knots

EQUIPMENT ON BOARD

VHF radio/telephone
Radar, GPS, AIS
TV, DVD player, CD music system
USB/Flash drive music connection, Wi-Fi
Refrigerator, deep freeze, ice machine
Speed boat with 50 hp engine & water-skis
Windsurf & 2 canoes
Snorkelling gear & fishing equipment
Full regulation safety & fire fighting equipment

ACCOMMODATION

8 air conditioned cabins
5 double cabins, 2 twin & 1 triple cabin
En suite bathrooms
Separate crew quarters